

## Riex GN58 sorter- from 300, 2x7.5L, H360, white



### Parametry

Marka	Riex
Kolor	Biały
Szerokość szuflady	300 mm
Wysokość szuflady	360 mm
Liczba koszy	2
Pojemność	15 litr
Strona katalogu	9.27

### Opis produktu

Riex GN58 Sorter - from 300 For those seeking a combination of elegance and durability, the Riex GN58 sorter delivers unmatched performance. This built-in waste bin is tailored to meet modern needs, seamlessly adapting to a wide range of furniture setups. Designed for installation at the bottom of a cabinet featuring standard side-opening doors, it consists of a complete assembly of a plastic frame with ball-bearing slides and an automatically opening lid. It is ideal for narrow cabinets starting from a width of 300mm. The lid on the containers opens automatically when the bin is pulled out. The container can be easily manipulated—pulled out and carried using the folding handles. The bins are manually extended by gripping the body of the bin. Key Features: Constructed from premium materials for enhanced durability and strength Easy to install, ensuring a hassle-free setup process Plastic frame with ball-bearing slides for smooth operation Automatically opening lid for added convenience Designed for narrow cabinets starting from 300mm in width

### Podobny przedmiot

#### Riex GN58 sorter- from 300, 1x16L, H360, white

F007645



## Instrukcja montażu (manual)

### Art. 280 - Art. 281 - Art. 282 - Art. 283 - Art. 284 - Art. 285 - Art. 286 - Art. 287 - Art. 289

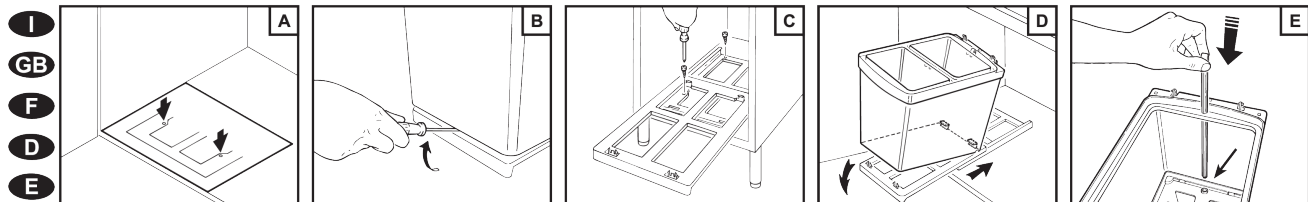

**I**  
**GB**  
**F**  
**D**  
**E**

Marcare i fori indicati.  
*Drill the marked holes.*  
Forez les trous indiqués.  
*Die angegebenen Bohrpunkte markieren.*  
Marcar los agujeros indicados.

Smontare l'involucro portasecchi.  
*Dismount the bucket tray.*  
Enlevez le plateau porte-seaux.  
*Die Eimerhülle abnehmen.*  
Desmontar el contenedor del cubo de basura.

Fissare la base.  
*Fit the base.*  
Fixez la base.  
*Den Rahmen anschrauben.*  
Apretar la base.

Rimontare l'involucro portasecchi.  
*Refit the bucket tray.*  
Montez à nouveau le plateau porte-seaux.  
*Die Eimerhülle einsetzen.*  
Montar otra vez el cubo de basura.

Inserire l'asta di sollevamento coperchio.  
*Fit the lid lifting bar into its special seat.*  
Introduisez la tige de levage.  
*Den Stab zum Anheben des Deckels einstecken.*  
Insertar el asta para el levantamiento de la tapa.

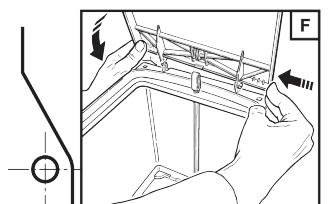

Agganciare, uno per volta, gli occhielli del coperchio come indicato.  
*Hook the eyelets of the cover one at a time as shown.*  
Accrochez les oeillets du couvercle un à la fois comme illustré en figure.  
*Nacheinander die Ösen des Deckels wie gezeigt einhängen.*  
Enganchar, uno a la vez, los ojal de la tapa como indicado.

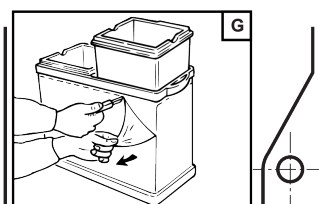

Rimuovere la pellicola trasparente solo se presente.  
*Remove the transparent film if present.*  
Enlevez la pellicule transparente, si présente.  
*Die transparente Folie, die die Eimerhülle bedeckt, abnehmen nur wenn anwesend.*  
Quitar la película transparente si presente.

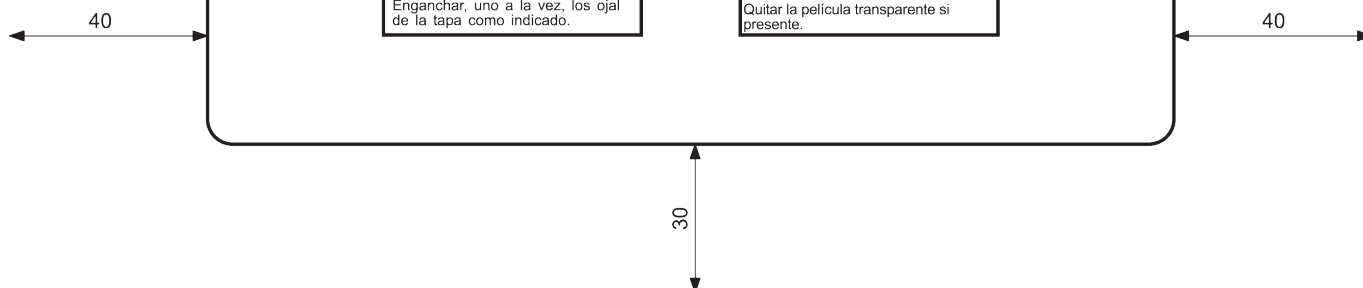

Rysunek 2D

